

Outlook Mobile Device Setup

iPhone:

1) Find the settings icon
(Location may vary)

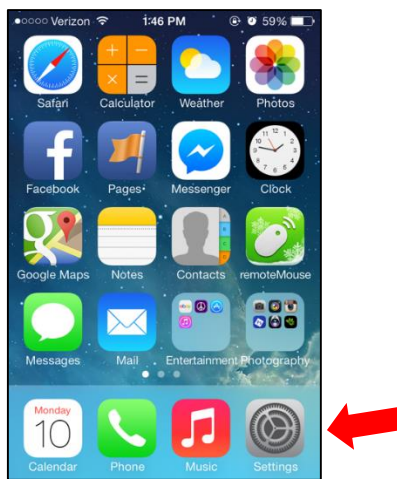

2) Once in settings scroll down to
Mail, Contacts, Calendars

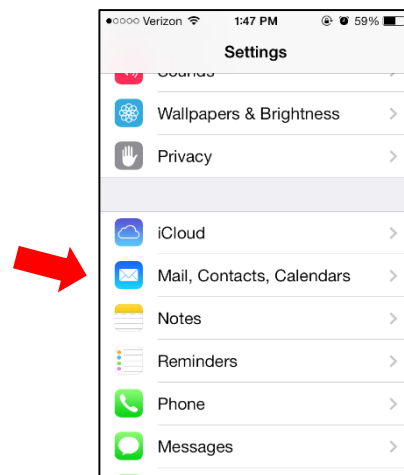

3) Select old exchange account then
delete it

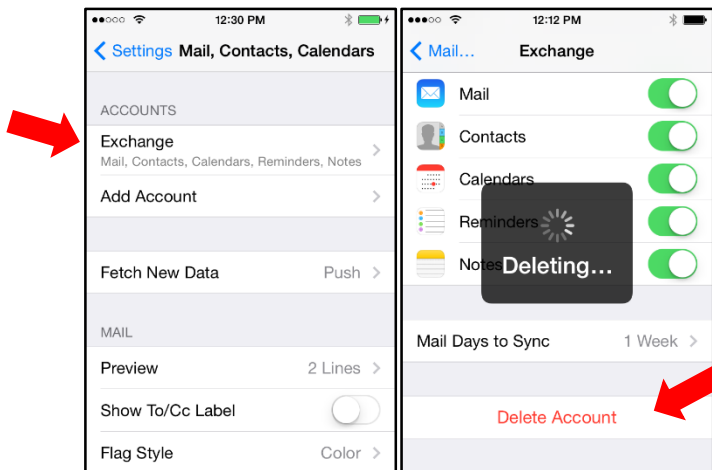

4) Select add account then select
Exchange

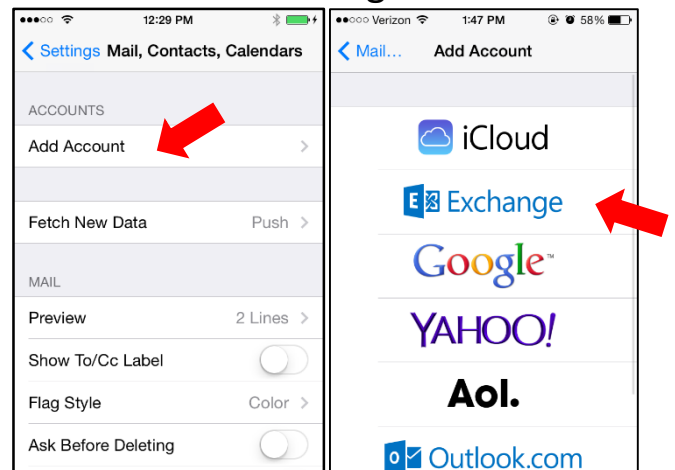

5) Fill in email, password, and description

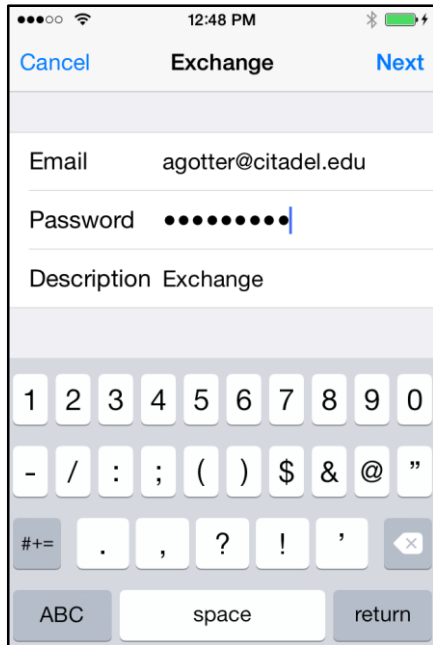

6) Settings for Office 365 Server

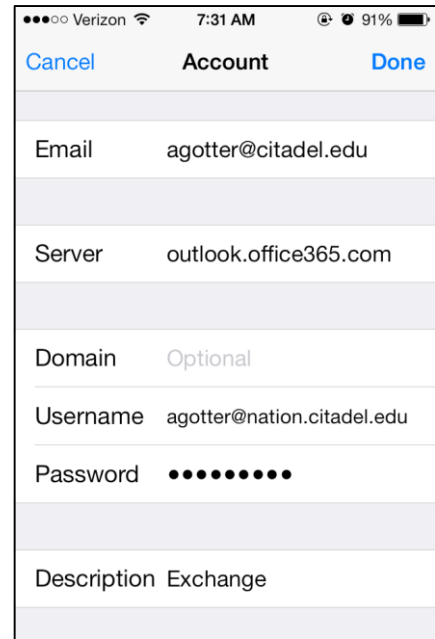

If you have any questions or concerns call (843) 953-HELP